

## FEATURES & SPECIFICATIONS

**INTENDED USE** — High performance parabolic luminaires for use in open area applications and electronic offices where optical control, visual comfort and light cut-off are important.

**ATTRIBUTES** — Design optimized for use with T8 lamps and low-profile electronic ballasts.

Choice of diffuse or specular louvers utilizing the latest developments in louver finishing for minimized louver iridescence.

**CONSTRUCTION** — Black reveal provides floating louver appearance, conceals optional air-supply slots.

Square corner end plates improve strength and durability.

Integral T-bar safety clips hold fixture to T-bar securely; no fasteners required.

Heavy-gauge hinges die-formed for maximum strength; spring action latches concealed in black reveal.

Housing formed from cold-rolled steel. Louver formed from anodized aluminum. No asbestos used in this product.

Overlapping flange and modular ceiling trims available factory installed with swing gate hangers or field convertible with optional trim and hangers.

**FINISH** — Five-stage iron-phosphate pretreatment ensures superior paint adhesion. Painted parts finished with high-gloss, baked white enamel.

**ELECTRICAL SYSTEM** — Thermally-protected, resetting, Class P, HPF, non-PCB, UL Listed, CSA certified ballast is standard.

Electronic ballasts are sound rated A.

Ballast disconnect provided standard where required to comply with US and Canadian electrical codes.

Fixture conforms to UL1570 and is suitable for damp locations. AWM, TFN or THHN wire used throughout, rated for required temperatures.

**LISTING** — UL Listed (Standard), CSA Certified or NOM Certified (see Options).

**WARRANTY** — Guaranteed for one year against mechanical defects in manufacture.

Catalog Number	
Notes	Type

**PARAMAX® Parabolic Troffer**

# 2PM3N 2'x4'

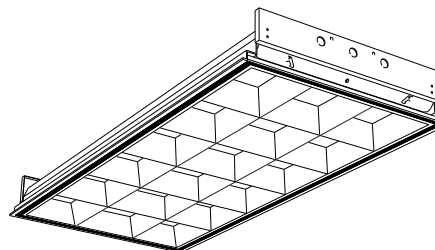

3" Louver Family

### Specifications

Length: 48 (1218)  
Width: 24 (609)  
Depth: 4-1/2 (114)  
Weight: 32 lbs (14.5 kg)

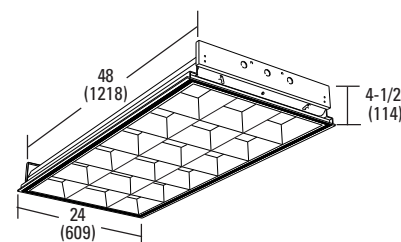

All dimensions are inches (millimeters). Specifications subject to change without notice.

## ORDERING INFORMATION

For shortest lead times, configure product using **standard options (shown in bold)**.

Example: 2PM3N G B 3 32 18LD MVOLT 1/3 GEB10IS

2PM3N		32				Options <sup>3</sup>	
Series	Air function	Lamp type	Voltage				
<b>2PM3N Paramax 3" louver family</b>	<b>B No air function</b>	<b>32 32W T8 (48")</b>	<b>MVOLT<sup>2</sup></b>			(blank)	<b>Two ballasts (three- and four-lamp only)</b>
	A Air supply/return (slots in side trim)	Number of lamps	120			<b>1/3</b>	<b>One 3-lamp ballast</b>
	H Heat removal (through lamp cavity, dampers available)	2	277			<b>1/4</b>	<b>One 4-lamp ballast</b>
	D Dual function supply/return/removal	3	347			1/41/2	Use with LST. One 4-lamp and one 2-lamp ballast.
		4	Others available.			<b>GEB10IS</b>	<b>Electronic ballast, ≤10% THD, instant start</b>
		Not included.				GEB10RS	Electronic ballast, ≤10% THD, rapid start
						<b>EL</b>	<b>Emergency battery pack (nominal 300 lumens)</b>
						<b>EL14</b>	<b>Emergency battery pack (nominal 1400 lumens)</b>
						<b>PWS1836</b>	<b>6' prewire, 3/8" dia., 18-gauge, 3 wires</b>
						<b>PWS1846</b>	<b>6' prewire, 3/8" dia., 18-gauge, 4 wires</b>
						<b>QFC313</b>	<b>Reloc Quick-Flex 12/3G, 13' <sup>4,5</sup></b>
						LST	Tandem fixture pairs (shared ballasts)
						LP	Lamped; specify lamp type and color
						<b>LP735</b>	<b>Lamped 700 Series, 3500K</b>
						GLR	Internal fast-blow fuse <sup>5</sup>
						GMF	Internal slow-blow fuse <sup>5</sup>
						ACS	Air closure strips (A and D models only)
						APB	Air-pattern control blades (A and D models only)
						PAF	Painted after fabrication (white enamel)
						2R	Two reflector channel covers <sup>6</sup>
						<b>JP</b>	<b>Palletized and stretch-wrapped (G trim only)</b>
						CSA	CSA Certified
						NOM	NOM Certified

### NOTES:

- Standard louver configuration:  
2 lamps = 12 cells, diffuse silver  
3 lamps = 18 cells, diffuse silver  
4 lamps = 32 cells, diffuse silver
- MVOLT standard for 120V and 277V applications. Some options require voltage specified.
- Some options increase fixture depth. Consult factory if plenum space is a concern.
- Must specify circuit wiring. Refer to [www.lithonia.com/Reloc](http://www.lithonia.com/Reloc) for additional information.
- Must specify voltage.
- Available with 3-lamp 18 or 24 cell only.

2PM3N 2'x4' 3" Louver Family

MOUNTING DATA

Continuous row mounting of flanged units requires CRE and CRM trim options. Consult factory.

Ceiling Type	Appropriate Trim Type
Exposed grid tee	G
Concealed grid tee	G, ST
Concealed Z-spline	F
Screw slot (consult factory)	ST
Acoustical tile, plaster or plasterboard on rigid support parallel to lamps	F

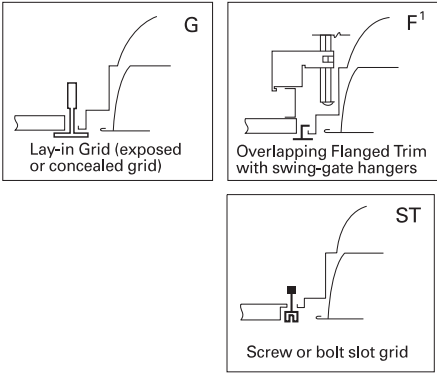

NOTE:  
1 Recommended rough-in dimensions for F trim fixtures 24"x48" (Tolerance is +1/4", -0"). Swing-gate range 1-7/16" to 3-7/16", span 23-1/2" to 26-7/16".

DIMENSIONS

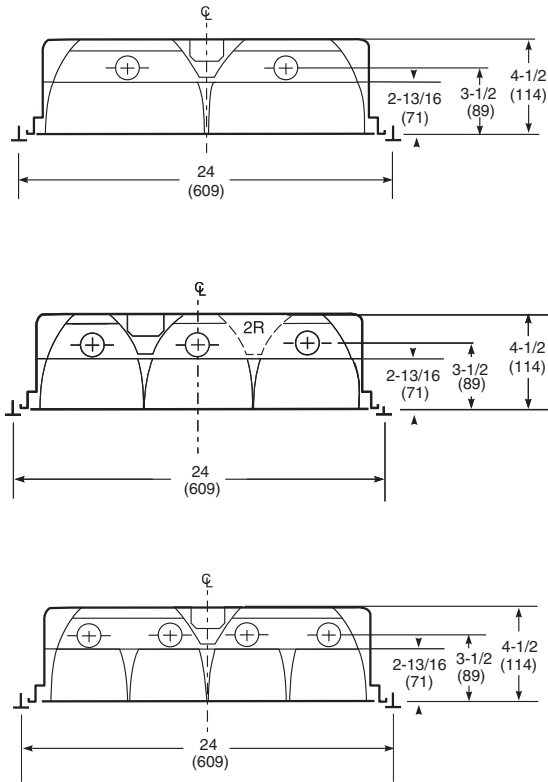

PHOTOMETRICS

Calculated using the zonal cavity method in accordance with IESNA LM41 procedures. Floor reflectances are 20%. Lamp configurations shown are typical. Full photometric data on these and other configurations available upon request.

Energy (Calculated in accordance with NEMA standard LE-5)					
LER.FP	ANNUAL ENERGY COST*	LAMP DESCRIPTION	LAMP LUMENS	BALLAST FACTOR	WATTS
65 (LD louver)	\$3.69	(2) 32WT8	2850	.88	59
66 (LD louver)	\$3.64	(3) 32WT8	2850	.88	85
59 (LD louver)	\$4.07	(4) 32WT8	2850	.88	112

\* Comparative yearly lighting energy cost per 1000 lumens.

TEST NO: LTL14496

2PM3N 2 32 12LD

LUMENS PER LAMP: 2850

LAMPS PER LUMINAIRE: 2

Coefficients of Utilization													
RCR	pf pc pw	80%			20%			70%			50%		
		50%	30%	10%	50%	30%	10%	50%	30%	10%	50%	30%	10%
0		91	91	91	89	89	89				85	85	85
1		82	79	76	80	77	75				77	75	73
2		72	67	63	71	66	63				68	64	61
3		64	58	53	62	57	53				60	56	52
4		56	50	45	55	49	45				53	48	44
5		50	44	39	49	43	38				48	42	38
6		45	38	34	44	38	33				43	37	33
7		41	34	29	40	34	29				39	33	29
8		37	31	26	36	30	26				35	30	26
9		34	28	23	33	27	23				32	27	23
10		31	25	21	31	25	21				30	25	21

Zonal Lumen Summary			
Zone	Lumens	% Lamp	% Fixture
0° - 30°	1177.9	20.7	26.9
0° - 40°	2015.8	35.4	46.1
0° - 60°	3919.0	68.8	89.6
0° - 90°	4372.0	76.7	100.0
90° - 180°	0.0	0.0	0.0
0° - 180°	4372.0	76.7	100.0

TEST NO: LTL14671

2PM3N 3 32 18LD

LUMENS PER LAMP: 2850

LAMPS PER LUMINAIRE: 3

Coefficients of Utilization										
RCR	pf pc pw	20%								
		80%			70%			50%		
		50%	30%	10%	50%	30%	10%	50%	30%	10%
0		89	89	89	87	87	87	83	83	83
1		80	78	75	79	76	74	76	74	72
2		71	67	63	70	66	63	67	64	61
3		64	58	54	62	57	53	60	56	53
4		57	51	46	56	50	46	54	49	45
5		51	45	40	50	44	40	49	44	40
6		46	40	35	45	39	35	44	39	35
7		42	36	31	41	35	31	40	35	31
8		38	32	28	38	32	28	37	31	28
9		35	29	25	34	29	25	34	28	25
10		32	26	23	32	26	23	31	26	22

Zonal Lumen Summary			
Zone	Lumens	% Lamp	% Fixture
0° - 30°	1982.1	23.2	30.9
0° - 40°	3413.2	39.9	53.1
0° - 60°	5866.8	68.6	91.4
0° - 90°	6422.1	75.1	100.0
90° - 180°	0.0	0.0	0.0
0° - 180°	6422.1	75.1	100.0

TEST NO: LTL14541

2PM3N 4 32 32LD

LUMENS PER LAMP: 2850

LAMPS PER LUMINAIRE: 4

Coefficients of Utilization										
RCR	pf pc pw	20%								
		80%			70%			50%		
		50%	30%	10%	50%	30%	10%	50%	30%	10%
0		79	79	79	77	77	77	74	74	74
1		71	69	67	70	68	66	67	65	64
2		64	60	57	63	59	56	60	57	55
3		57	53	49	56	52	48	54	51	48
4		51	46	42	50	46	42	49	45	42
5		46	41	37	46	41	37	44	40	37
6		42	37	33	41	36	33	40	36	32
7		38	33	29	38	33	29	37	32	29
8		35	30	26	35	30	26	34	29	26
9		32	27	24	32	27	24	31	27	23
10		30	25	22	29	25	21	29	24	21

Zonal Lumen Summary			
Zone	Lumens	% Lamp	% Fixture
0° - 30°	2650.0	23.2	35.1
0° - 40°	4348.4	38.1	57.6
0° - 60°	7076.5	62.1	93.7
0° - 90°	7551.8	66.2	100.0
90° - 180°	0.0	0.0	0.0
0° - 180°	7551.8	66.2	100.0