



Hammond
Power Solutions



UL LISTED
31GW E258346

GUELPH, ONT. BARABOO, WI COMPTON, CA MONTERREY, MX

SINGLE PHASE DRY TYPE TRANSFORMER
TRANSFORMATEUR SEC MONOPHASE

HV/HT	190/200/208/220/380/400/416/440V				Cust. Ref.	
BIL	-				Réf. du client	
TERM. BORNES	H1 H2				Serial No.	
					No. de série	
					Part No.	Q015XEKF
					No. de pièce	
					kVA	15
					TYPE	HZQ
					Cooling	ANC
					Refroidissement	
					Temp. Rise	115 °C
					Echauffement	
					Temp. Class	180 °C
					Classe de Temp.	
					Frequency	50/60Hz
					Fréquence	
					Impédance	
					Voltage	
					Impédance %	2.3
					@ 135 °C	
					Encl. Type	3R / IP33
					Type de boîtier	
					Wt LBS	275
					Poids en lbs.	
					Winding	COPPER
					Enroulement	
					COMPLIES WITH EN61558-1/EN61558-2-1	
					GENERAL PURPOSE TRANSFORMER	
					FOR USE IN HAZARDOUS LOCATIONS	
					ABS TYPE APPROVAL NO. 14-HS1174640-PDA	
					ELECTROSTATIC SHIELD	
					TEMPERATURE CLASSIFICATION: T3A	

VOLTS	CURRENT COURANT	% RATED VOLTAGE % TENSION NOMINALE	CONNECTION EACH PHASE CONNEXION PAR PHASE
190V	78.9		H1-8 & H2-7
200V	75.0		H1-6 & H2-5
208V	72.2		H1-4 & H2-3
220V	68.3		H1-2 & H2-1
380V	39.5		7-8
400V	37.5		5-6
416V	36		3-4
440V	34.1		1-2

120V/240V			
-			
X4 X2 X3 X1			

Diagram showing two transformer configurations. The first configuration shows a single-phase transformer with primary terminals H1 and H2, and secondary terminals X4, X2, X3, and X1. The second configuration shows a similar setup with different terminal connections. The diagram is labeled 'D0010033piece'.



Hammond Power
Solutions Inc.

TITLE: 1 PHASE ENCAPSULATED TRANSFORMER
NAMEPLATE INFORMATION

1	08/01/05	RB	HCN: 27751	DES: WWONG
NO.	DATE	BY	REVISION	SCALE: NTS

SHEET 1 OF 3

EDBQ015XEKF

1.4 wong 2016/11/09 16:38



HPS TITAN

General Purpose Transformer for use in Hazardous Locations

Class I, Division 2, Groups A, B, C, & D
Class I, Zone 2, Group IIC, T3
Hazardous Locations

**WARNING - EXPLOSION HAZARD - DO NOT DISCONNECT
EQUIPMENT WHILE THE CIRCUIT IS LIVE OR UNLESS THE AREA
IS KNOWN TO BE FREE OF IGNITABLE CONCENTRATIONS.
WARNING - EXPLOSION HAZARD - SUBSTITUTION OF ANY
COMPONENT MAY IMPAIR SUITABILITY FOR
CLASS 1, DIVISION 2.**

LAB62181



**Hammond Power
Solutions Inc.**

TITLE: 1 PHASE ENCAPSULATED TRANSFORMER

1	08/01/05	RB	HCN: 27751	DES: WWONG
NO.	DATE	BY	REVISION	SCALE: NTS

SHEET 2 OF 3

EDB0015XEKF

1.4 wwong 2016/11/09 16:38

FRONT VIEW

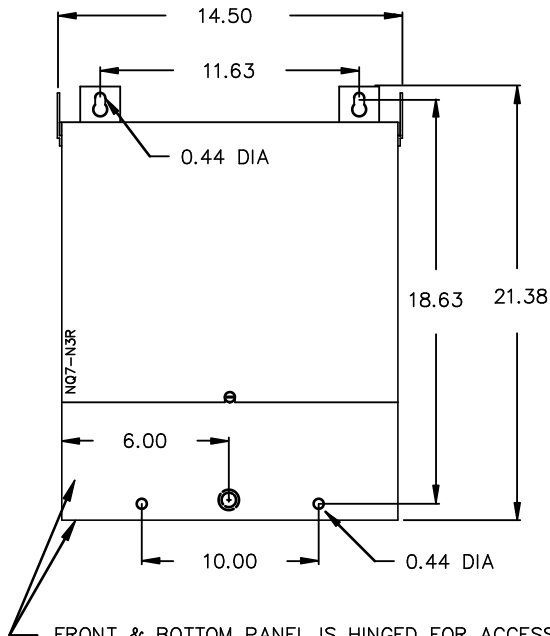

SIDE VIEW

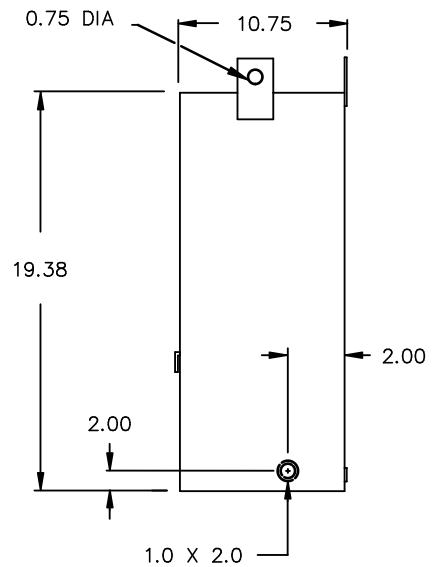

FRONT & BOTTOM PANEL IS HINGED FOR ACCESS TO
TERMINALS, BOTTOM MOUNTING HOLES AND REAR KNOCKOUT.

All Dimensions in inches

ENCLOSURE COLOR : ANSI 61 GREY – OUTDOOR

L.V.1. TERMINAL DETAIL

MECHANICAL TYPE LUGS INCLUDED
SUITABLE FOR #14-2 CU/AL
CONDUCTORS
1 CONDUCTOR PER PHASE

CUSTOMER NOTES:

- HV1 TERMINATED AT BOTTOM FRONT SEW LEADS
- LV1 TERMINATED AT BOTTOM REAR



TITLE: 1 PHASE ENCAPSULATED TRANSFORMER

1	08/01/05	RB	HCN: 27751	DES: WWONG
NO.	DATE	BY	REVISION	SCALE: NTS

SHEET 3 OF 3

EDB0015XEKF

1.4 wong 2016/11/09 16:38